

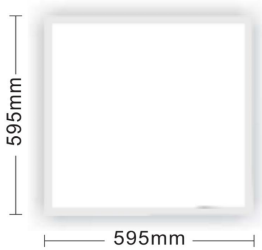

MODEL	Wattage (W)	Efficacy (lm/w)	Colour Temp(K)	CRI
PL-6012	<input type="checkbox"/> 50	* <input type="checkbox"/> 100	<input type="checkbox"/> 3000	<input type="checkbox"/> Ra>80
		<input type="checkbox"/> 110	* <input type="checkbox"/> 4000	
		<input type="checkbox"/> 120	* <input type="checkbox"/> 5000	

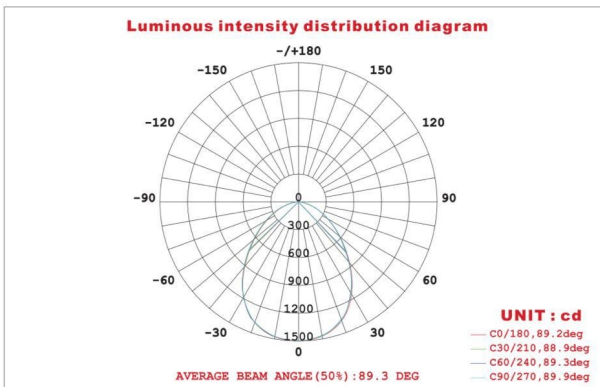

MODEL	Wattage (W)	Efficacy (lm/w)	Colour Temp(K)	CRI
PL-6060	<input type="checkbox"/> 26	* <input type="checkbox"/> 100	<input type="checkbox"/> 3000	<input type="checkbox"/> Ra>80
	<input type="checkbox"/> 30	<input type="checkbox"/> 110	* <input type="checkbox"/> 4000	
	<input type="checkbox"/> 36	<input type="checkbox"/> 120	* <input type="checkbox"/> 5000	
	* <input type="checkbox"/> 40			



- 1.Split Mounting Frame Structure
- 2.Suitable for integral solid ceiling installation
- 3.Small packaging size, easy transportation, saving freight cost.

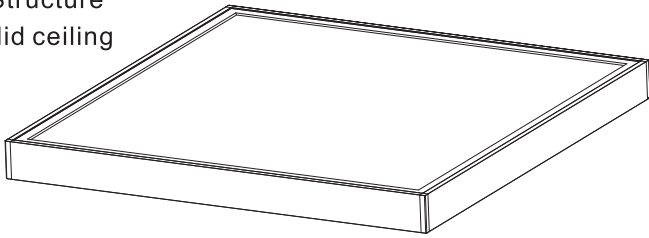

Assembled Surface Mounted Frame

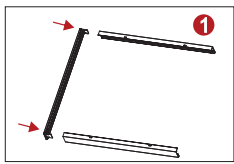

1. Assemble the 3 pieces of frame by metal bracket

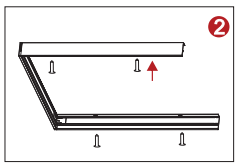

2. Fix the square frames in to ceiling with Screw.

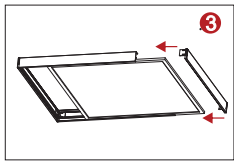

3. Insert the panel into frames and fix the c

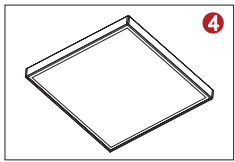

4. Finished frame installation

Suspension Kits

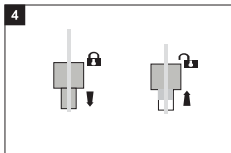
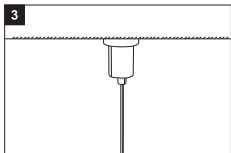
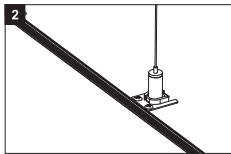
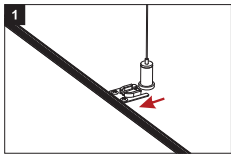

Stainless steel
4PCS/set
Main cable:1.2m
(hook+column ceiling kit)
Accessories C
4PCS/set



Stainless steel
2PCS/set
Main cable:1.2m
Branch cable:0.35m
Triangle rings
4PCS/set



Safety cable
1PCS/set
Main cable:2m



Spring Clips
L46*W29.5*H18.5